



LOWER MINNESOTA RIVER WATERSHED DISTRICT

Executive Summary for Action

Lower Minnesota River Watershed District Board of Managers Meeting

Wednesday, June 17, 2020

Agenda Item

Item 6. A. - Larson 2020 Cost Share Application - 1033 Sunny Ridge Drive, Carver

Prepared By

Linda Loomis, Administrator

Summary

At the May meeting a decision on this Cost Share application was tabled pending additional information. The Board requested more detailed information regarding the costs of the project.

Ms. Larson has provided more information regarding the costs of the project. The total cost of the project is \$5,878.13. The LMRWD Cost Share program allows for grants on residential properties of 50% of the project cost up to a maximum of \$2,500. 50% of the cost of this project is \$2,393.07 so the homeowner is eligible for reimbursement of \$2,500. Rain gardens are allowed projects under the Cost Share program.

Attachments

Larson Cost Share application with additional information regarding the cost.

Recommended Action

Motion to approve cost share application for 1033 Sunny Ridge Drive, Carver



Application type (check one) Homeowner Non-profit - 501(c)(3) School
 Business or corporation Public agency or local government unit

Project type (check all that apply) Raingarden Vegetated Swale Infiltration Basin
 Wetland restoration Lake/creek/wetland buffer Conservation practice
 Shoreline/bank stabilization Pervious hard surface
 Other Pollinator habitat garden

Applicant Information

Name of Organization or Individual Applying for Grant (to be named as Grantee):

Renee Larson

Address (street, city and ZIP code):

1033 Sunny Ridge Dr, Carver, MN 55315

Phone: 612-280-9763 Email address: cattygiles@gmail.com

Primary Contact (if different from above)

Name of Organization or Individual Applying for Grant (to be named as Grantee):

Address (street, city and ZIP code):

Phone: _____ Email address: _____

Project location

Address (street, city and ZIP code):

1033 Sunny Ridge Drive, Carver, MN 55315

Property Identification Number (PID)

20.4500100

Property Owners:

Renee Larson

Project Summary

Title Larson Raingarden 2020

Total Project Cost 5878.13 Grant amount requested 2939.00

Estimated start date May 15, 2020 Estimated completion date July 1, 2020

Is project tributary to a water body? No, water remains on site Yes, indirectly Yes, directly adjacent

Project description:

SEE ATTACHMENT 1

Is this work required as part of a permit? No Yes

(If yes; describe how the project provides water quality treatment beyond permit requirement on a separate page.)

Project Details

Checklist To be considered complete the following must be included with the application.

location map ATTACHMENT 3(b) project timeline ATTACHMENT 1

site plan & design schematic ATT 3(a) proof of property ownership ATTACHMENT 4

itemized budget or contractor bid ATT 4 plant list & planting plan (if project includes plants) ATT 3(a)

Description

Describe the current site conditions, as well as site history, and past management

SEE ATTACHMENT 2 #1

What are the project objectives and expected outcomes? Give any additional project details.

SEE ATTACHMENT 2 #2

List other key participants and their roles (provide contact information for each partner and his/her expected contribution to the project)

Renee Larson 612-280-9763 cattygiles@gmail.com
Owner

David Pierson 612-251-9910 info@piersonlandscape.com
Pierson Garden and Landscape, Owner

Which cost share goals does the project support? (check all that apply)

improve watershed resources

Foster water resource stewardship

increase awareness of the vulnerability of watershed resources

increase familiarity with and acceptance of solutions to improve waters

How does the project support the goals you checked?

- Increases awareness with front yard exposure and expansiveness of project.
- Displays aesthetically pleasing manner to collect runoff of water and filtration of road debris.
- Increases familiarity with and acceptance of improving waters by being the first homeowner on Sunny Ridge Drive to put in a raingarden which may engage other homeowners in the area to do the same.

Project Details (continued)

Benefits Estimate the project benefits in terms of restoration and/or annual pollution reduction. If you are working with a designer or contractor, they can provide these numbers. If you need help contact the district Administrator.

Benefit	Amount
Water captures	unknown gal/year
Water infiltrated	unknown gal/year
Phosphorus removed	unknown lbs/year
Sediment removed	unknown lbs/year
Land restored	1,500 sq. ft.

How will you share the project results with your community?

- Next Door
- Facebook
- Word of mouth
- Site may also be used in Pierson Garden & Landscape advertising as per ATTACHMENT 2

Are there other projects that could be initiated as a result of this one?

Possibility of a second raingarden on the west side of the driveway.

Evaluation

How will the project be monitored and evaluated?

Project will be monitored by the homeowner who will follow watering and maintenance guidelines provided by Pierson Garden & Landscape.

Maintenance agreement

I acknowledge that receipt of a grant is contingent upon agreeing to maintain the project for the number of years outlined in the cost share guidelines. Yes

Authorization

Name of landowner or responsible party Renae Larson

Signature Renae Larson Date 5/11/2020

Type or handwrite your answers on this form. Attached additional pages as needed

(For questions, contact Linda Loomis at NaiadConsulting@gmail.com or call 763-545-4659.)

Mail the completed application to:

or Email to:

Lower Minnesota River Watershed District
c/o Linda Loomis, Administrator
112 E. Fifth St., Suite 102
Chaska, MN 55318

Linda Loomis, Administrator
naiadconsulting@gmail.com

ATTACHMENT 2

Description

- 1) The house was built in 1986. Renae Larson is the original and only owner. The home sits lower than Sunny Ridge Drive. Therefore, the angle of the driveway slopes down towards the house from the street. Rainwater (and at times road debris such as salt, sand, dirt) run from the street into the driveway and pools at the northeast side. In 2009, the City of Carver installed curb and gutter on Sunny Ridge Drive. A better driveway was constructed, but since the house sits lower than the road, rainwater still collects at the northeast portion of the driveway. To temporarily mitigate this, a small trench was formed in the turf as a collection point. Mulch was added around the area. See pictures below.



- 2) The project objectives are to provide approximately 1500 sq. ft. area for rainwater to drain from the driveway into a small infiltration basis (currently the trench). The project includes a pollinator habitat with many flowering perennials. Plants used will be suitable for the dry and wet areas of the raingarden. See ATTACHMENT 1 for project details.

ATTACHMENT 3(a)



PIERSON GARDEN AND LANDSCAPE
 "CUSTOM LANDSCAPE HAPPINESS!"

DAVID PIERSON • PHONE: (612) 251-9910

ORNAMENTAL GRASSES

SUMAC

COMPACT COLUMNAR PINE

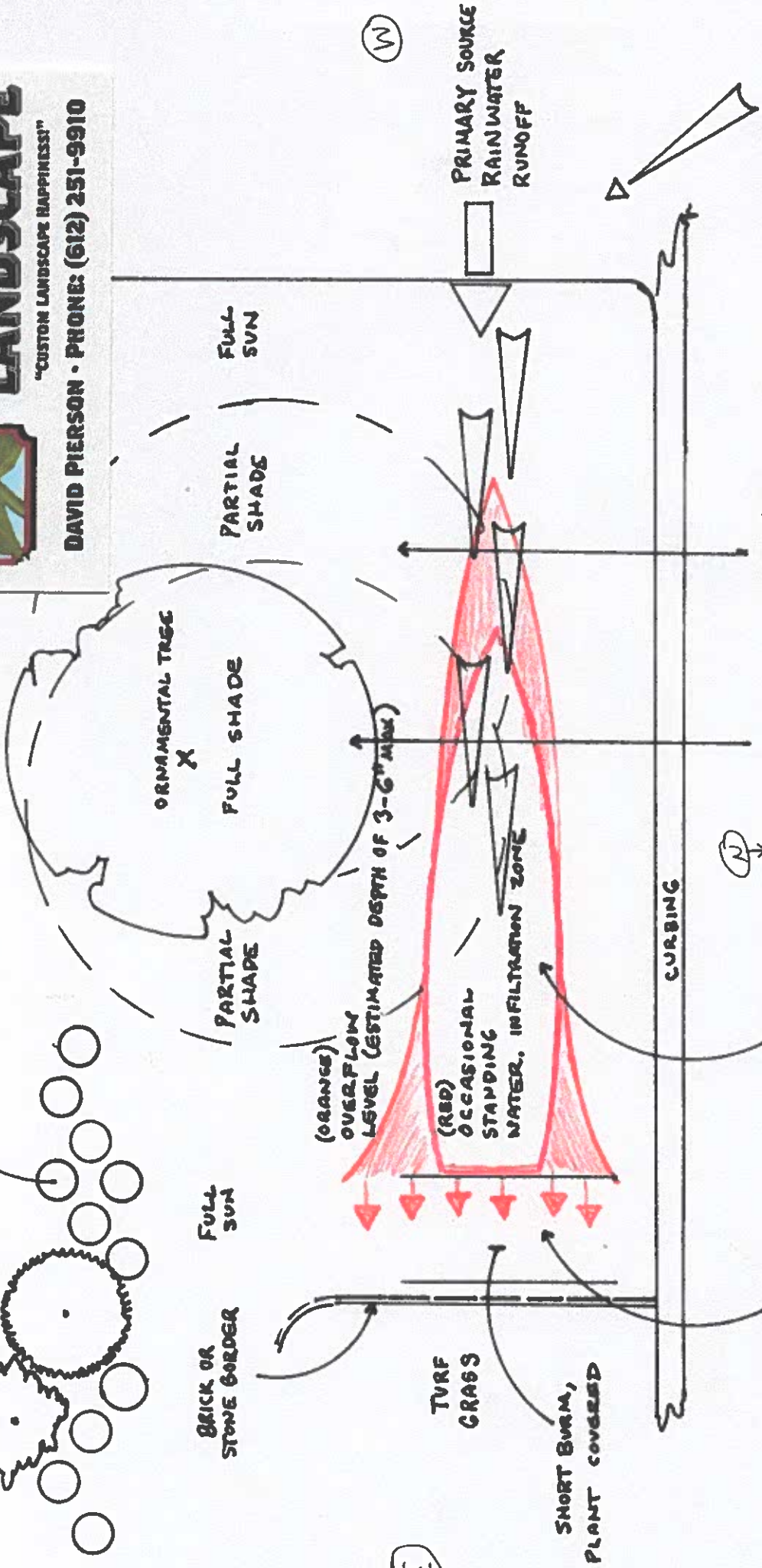
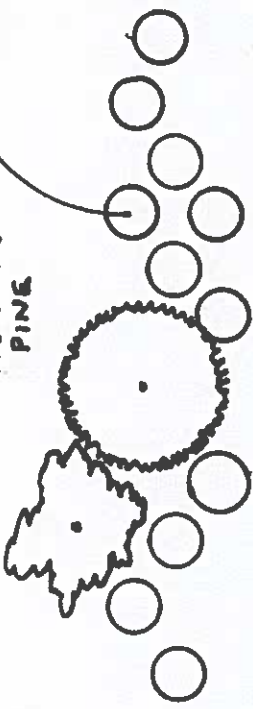

(W)

PRIMARY SOURCE RAINWATER RUNOFF

SECONDARY SOURCE OF RAINWATER RUNOFF (MINIMAL)

MESIC/DRY PARTIAL SHADE RECOMMENDATIONS:

DRY SHADE RECOMMENDATIONS:

MESIC/RAINGARDEN RECOMMENDATIONS:

MESIC/DRY RECOMMENDATIONS:

- AQUILEGIA
- CAREX PENNSYLVANICA
- POLYGONUM
- PHYSOSTEGIA

- AQUILEGIA
- GERANIUM (MLD)
- UVULARIA

- ECHINACEA PURPUREA
- LIATRIS
- IRIS
- LOBELIA
- CORSOPIA

- ASCLEPIAS MILKWEED
- BUTTERFLY FLOWER
- BAPTISIA
- ASTER
- RUDBECKIA HIERTA
- MONARDA
- SCHIZACHYRIUM LITTLE BLUESTEM

NET/RAINGARDEN SHADE: GALIUM, IRIS (FLAG)

(E)

ATTACHMENT 3(b)
Location map2



Pierson Garden and Landscape

PO BOX 114
Victoria, MN 55368
612-251-9910



INVOICE

BILL TO

Renaee Larson
1033 Sunny Ridge Drive
Carver, MN 55315-9355

INVOICE # 1381

DATE 05/17/2020

DUE DATE 05/25/2020

TERMS Due upon
completion

Page 2: Materials delivered

Page 3: Locations of planted materials

Page 4: Plants that will be planted once received (late June)

Page 5: Detailed pricing break-down

Page 6: Pricing Invoice (Summary)



5500 Blaine Ave | Inver Grove Heights, MN 55076
651.450.1501 | gertens.com

#2 REVISED

PAGE NO 1



CUST NO: 106616	JOB NO: 000	PURCHASE ORDER: 1033 SUNNY RIDGE	REFERENCE: AM FRI 5/22	TERMS: NET 15TH	CLERK: 1580	DATE / TIME: 5/20/20 8:06
--------------------	----------------	-------------------------------------	---------------------------	--------------------	----------------	------------------------------

SOLD TO:
PIERSON GARDEN & LANDSCAPES
9810 CO RD 43

CHASKA MN 55318
612-251-9910

SHIP TO:
DAVID - 612.251.9910
1033 SUNNY RIDGE DRIVE

CARVER MN 55315

DEL DATE: 5/22/20
SALESPERSON: AC ANGELA CESAR
TAX: CRV CARVER COUNTY
TERMINAL: 419

ORDER: 379185/6

LINE	SHIPPED	ORDERED	UM	SKU	DESCRIPTION	LOCATION	UNITS	PF
1					SHADE			
2		4	EA	NR0240	AQUIL CANADENSIS 3.5"/18T		4	
3		1	EA	NR3310	CAREX PEN COMMONOAKSEEDGE3.5"/18T	E20	1	
4		3	EA	NR2555	SOLID SPE SHOWYGOLDENROD3.5"/18T	E26	3	
5		4	EA	NR0305	ASCLE INC SWAMPMILKWEED 3.5"/18T	E20	4	
6		4	EA	NR0355	ASCLE TUB BUTTERFLYWEED 3.5"/18T		4	
7		3	EA	NR0705	BAPTI AUS BLUEFALSEINDIG3.5"/18T		3	
8		2	EA	NR0555	ASTER NOV ANG NEWENGLAND3.5"/18T	E20	2	
9		6	EA	NR1175	ECHIN PURPUREA 3.5"/18 TRAY	E25	6	
11		2	EA	NR1655	LIATR LIG MEADOWBLAZINGS3.5"/18T		2	
12					N/A TILL LATE MAY '20			
13		1	EA	NR1605	LIATR ASP ROUGHBLAZINGST3.5"/18T	E25	1	
14		6	EA	NR2135	RUDBE FULGIDA 3.5"/18T	E20	6	
15		2	EA	NR2605	TRADE OHI OHIOSPIDER3.5"/18T		2	
16		2	EA	NR2800	ZIZIA AUR GOLDEN ALEX 3.5"/18T		2	
17		2	EA	NR1555	IRIS VER BLUE FLAG IRIS 3.5"/18T	E20	2	
18		2	EA	NR2005	PENST DIG SMOOTH 3.5"/18T		2	
19		1	EA	NR4055	SPORO HET PRAIRIEDROPS3.5"/18T	E25	1	
20						E54		
21					HOUSE	E54		
22		2	EA	NR4055	SPORO HET PRAIRIEDROPS3.5"/18T	E25	2	
23		1	EA	NR0705	BAPTI AUS BLUEFALSEINDIG3.5"/18T		1	
24		1	EA	E2141	PINUS MUGO COLUMNARIS #15/3'		1	
25		1	EA	S2290	RHUS TYP TIGER EYE SUMAC #2 FE1.	S13	1	
26		30	EA	G0080	CALAM ACU KARL FOERSTER #1	E44	30	
27					PLANT 12 @ SUNNY RIDGE	S9		
28					HOWIE	S9		
29		2	EA	T1187.7	BETULA POP WHITESPIRE #25 TF	S9	2	
30					LOW INVENTORY	S9		
31					MAY SUB #15TF	S9		
32						S9		
33						S9		
34		1	EA	55315W	55315 ZIPCODE DELIVERY		1	

SUNNY RIDGE

LEAVE ROOM

YELLOW HIGHLIGHTS ARE FOR LARSON, SUNNY RIDGE

ALL OTHERS GO TO DAVES

Continued...

o 1 Columbine too many
o missing 1 _____?



Rain Garden

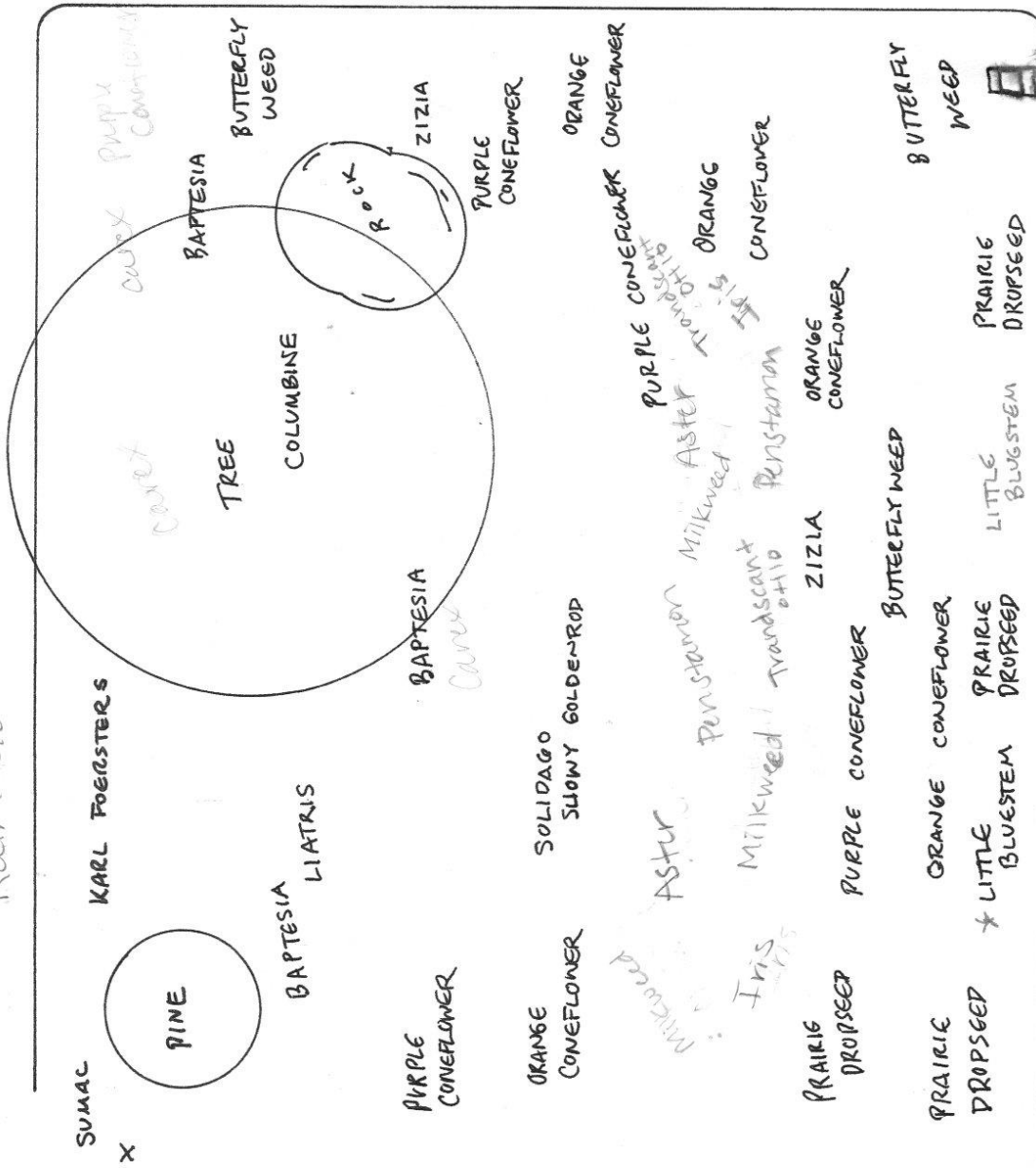

Remaining plant materials on page 4 are not yet included in the sketch above.

- Missing
- 18 Liatris 'Meadow'
 - 10 Virginia Bluebell
 - 10 Trillium
 - 1 Lady In Red
 - 18 Marsh Marigold
 - 36 Little Bluestem

Grower expects product to be available 6/30/20. Install will be done when available

1 flat went to Dale

1 flat was a mishap

Pricing for above plant material and labor already included in totals on Invoice.

Total plant materials including state and local tax:	\$2,300.60*
Total non-taxable labor:	<u>\$1,829.52**</u>
Total new landscape improvement (First line on Invoice, pg 6)	\$4,130.12

*Price of all plants = $\$2,300.60 / 850$ plants = approximately \$2.71 per plant

**Price of installation labor = $\$1,829.52 / 850$ plants = approximately \$2.15 per plant

Total price of mulch (8 cubic yards) including tax:	\$413.01
Delivery of mulch:	\$100.00
Installation of mulch:	<u>\$400.00</u>
Total New Hardwood mulch as part of initial landscape construction:	\$913.01

Pierson Garden and Landscape
PO BOX 114
Victoria, MN 55368
612-251-9910



INVOICE

BILL TO

Renaee Larson
1033 Sunny Rldge Drive
Carver, MN 55315-9355

INVOICE # 1381

DATE 05/17/2020

DUE DATE 05/25/2020

TERMS Due upon
completion

ACTIVITY	QTY	RATE	AMOUNT
Non-taxable Services:Landscape Improvement Installation Initial landscape construction to improve real property. Native plant materials including installation and bulk delivery	1	4,130.12	4,130.12
Non-taxable Services:Offsite haul away and disposal Offsite haul-away and disposal per trailer, NO ADDITIONAL CHARGE	0	98.00	0.00
Non-taxable Services:Landscape Improvement Installation Initial landscape construction to improve real property. New hardwood mulch including installation and bulk delivery	1	913.01	913.01
Non-taxable Services:Landscape Improvement Installation Initial landscape construction to improve real property. Grading.	1	835.00	835.00
		PAYMENT	587.00
		BALANCE DUE	\$5,291.13

Paid in full.